

PROPOSED ADDITIONS AND ALTERATIONS TO EXISITING DWELLING

WITH NEW GRANNY FLAT

72 CENTAUR STREET REVESBY

ISSUE FOR DEVELOPMENT APPLICATION CITY OF CANTERBURY & BANKSTOWN COUNCIL

DRAWING LIST:

SHEET TITLE	SHEET NUMBER
COVER PAGE	01
LANDSCAPE PLAN	02
PLANTING SCHEDULE AND NOTES SPECIFICATIONS PLAN	03

unique garden design

WILLOUGHBY NSW 2068

MOB: 0413 773 228

E:ugdesign@outlook.com

ABN: 73 185 501 266

LDI Member No: 531

AMENDMENTS	DESCRIPTION	BY	DATE
REVISION A	SUBMISSION FOR COUNCIL	SA	8.04.2025

CONSULTANT:	-
DRAWING NO:	2025-142
DATE:	8.04.2025

PROJECT:	72 CENTAUR STREET REVESBY
SHEET NO.	01
DRAWING BY:	SA

DRAWING TITLE:	COVER PAGE
REV.	A
SCALE:	-

Landscape
Design
Institute

Professional Member
Membership Number: 531

NOTE:
UNIQUE GARDEN DESIGN IS THE OWNER
OF THE COPYRIGHT SUBSISTING IN
THESE DRAWING,PLAN,DESIGNS AND
SPECIFICATION.
THEY MUST NOT BE COPIED,USED OR
REPRODUCED IN WHOLE OR IN ANY
PART, NOR MAY THE INFORMATION,
AND CONCEPTS IDEAS THEREIN
CONTAINED (WHICH ARE CONFIDENTIAL
TO UNIQUE GARDEN DESIGN) BE
DISCLOSED TO ANY PERSON WITHOUT
THE PRIOR WRITTEN CONSENT.
DO NOT SCALE DRAWINGS.
ALL DIMENSIONS MUST BE VERIFIED ON
SITE.

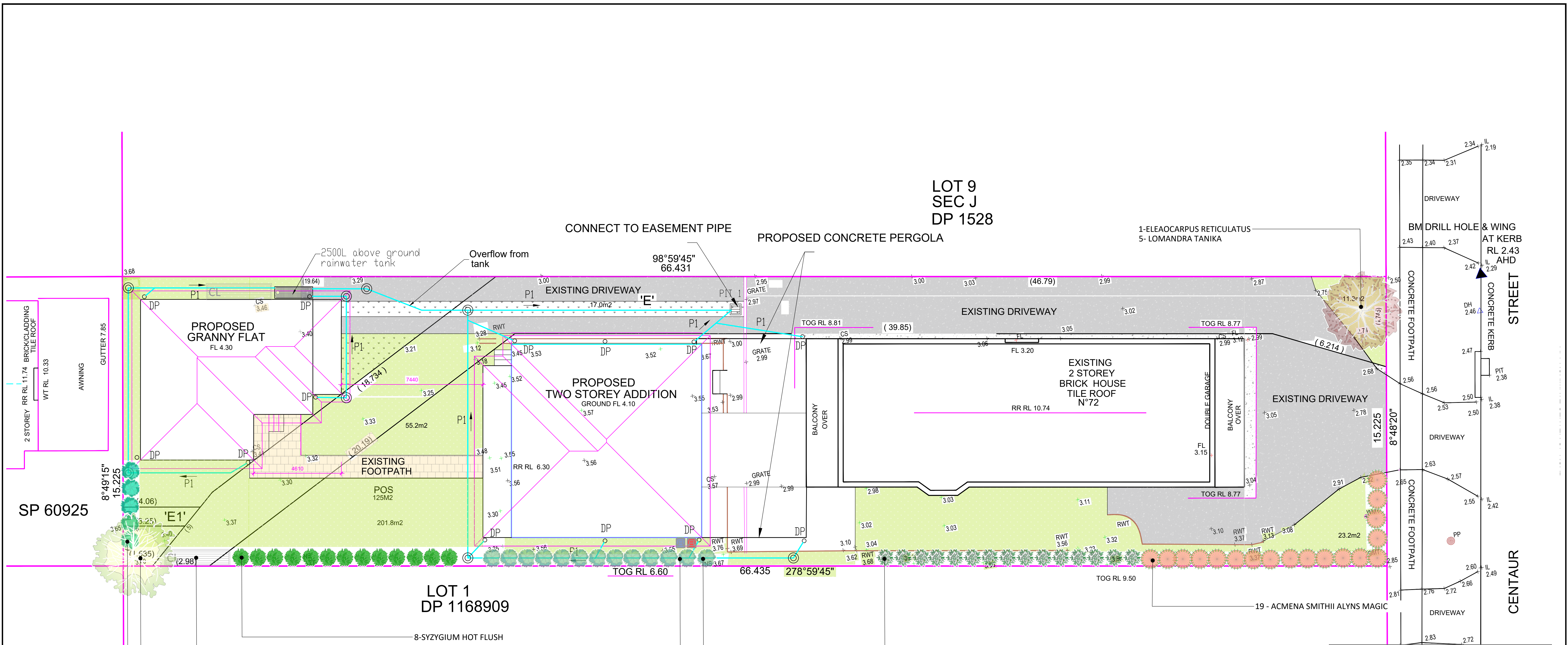

LEGEND:

- 2 - PROPOSED TREES
REFER TO PLANTING SCHEDULE
- PROPOSED HEDGING PLANTS
REFER TO PLANTING SCHEDULE
- PROPOSED LOW SHRUB & GRASSES
REFER TO PLANTING SCHEDULE
- SITE BOUNDARY
- CLOTHES LINE
- 250mm GARDEN BED
- SOFT LANDSCAPE AREAS
- CONCRETE AREAS
- PROPOSED PAVEMENT
- POOL
- BINS
- STORM WATER PIT
REFER TO STORM WATER PLAN
- RAINWATER TANK
REFER TO STORM WATER PLAN

unique garden design

WILLOUGHBY NSW 2068
MOB: 0413 773 228
E: ugdesign@outlook.com
ABN: 73 185 501 266
LDI Member No: 531

AMENDMENTS	DESCRIPTION	BY	DATE
REVISION A	SUBMISSION FOR COUNCIL	SA	8.04.2025

CONSULTANT:	-
DRAWING NO:	2025-142
DATE:	8.04.2025

PROJECT:	72 CENTAUR STREET REVESBY
SHEET NO.	02
DRAWING BY:	SA

DRAWING TITLE:	LANDSCAPE PLAN
REV.	A
SCALE:	1:100 @ A1

Landscape Design Institute

Professional Member
Membership Number: 531

NOTE:
UNIQUE GARDEN DESIGN IS THE OWNER OF THE COPYRIGHT SUBSISTING IN THESE DRAWING, PLAN, DESIGNS AND SPECIFICATION.
THEY MUST NOT BE COPIED, USED OR REPRODUCED IN WHOLE OR IN ANY PART, NOR MAY THE INFORMATION, AND CONCEPTS IDEAS THEREIN CONTAINED (WHICH ARE CONFIDENTIAL TO UNIQUE GARDEN DESIGN) BE DISCLOSED TO ANY PERSON WITHOUT THE PRIOR WRITTEN CONSENT.
DO NOT SCALE DRAWINGS.
ALL DIMENSIONS MUST BE VERIFIED ON SITE.

PROPOSED PLANTING SCHEDULE

BOTANICAL NAME		COMMON NAME	QTY	POT SIZE	SPACING	MATURE SIZE (H x W)
TREES						
ER	LEAOCARPUS RETICULATUS	BLUE BERRY ASH	1	45L	AS SHOWN	8.0x4.0m
LI	LAGERSTROEMIA INDICA	CREPE MYRTLE	1	45L	AS SHOWN	8.0x4.0m
SHRUBS / FILLERS / SCREENING PLANTS						
ASV	ACMENA SMITHII VAR MINOR	SMALL LEAFED LILY PILLY	19	200mm	800mm	2.5x1.5m
GM	GREVILLEA MOONLIGHT	GREVILLEA	3	200mm	800mm	2.5x1.5m
ME	METROSIDEROS EXCELSA	POHUTUKAWA	5	200mm	800mm	2.5x1.5m
MP	MURRAYA PANICULATA	ORANGE JASMINE	15	200mm	800mm	2.5x1.5m
SHF	SYZYGium HOT FLUSH	LILLY PILLY	8	200mm	800mm	2.5x1.5m
VO	VIBURNUM ODORATISSIMUM	SWEET VIBURNUM	10	200mm	800mm	2.5x1.5m
GROUND COVERS						
DC	DIANELLA CAERULEA 'LUCIA'	BLUE FLAX LILY	5	140mm	400mm	0.5x0.5m
LM	LOMANDRA TANIKA	LOMANDRA	6	140mm	400mm	0.5x0.5m

SITE PREPARATION/SOIL WORKS:

ALL EXISTING TREES MARKED FOR RETENTION SHALL BE PROTECTED FOR THE DURATION OF THE BUILDING WORKS. REMOVE FROM SITE ALL PERENNIAL WEEDS SUCH AS OXALIS, ONION WEED AND THE LIKE.

NO REGARDING IS TO BE CARRIED OUT WITHIN THE DRIP LINE OF THE TREES TO BE RETAINED. WHERE EXCAVATION IS NECESSARY USE HAND METHODS TO AVOID DAMAGE TO THE ROOT SYSTEM. DO NOT CUT GREATER THAN 50MM. CUT ROOTS CLEANLY WITH A SAW AND DO NOT SEAL THE WOUND.

SOIL WORKS:

THOROUGHLY CULTIVATE THE SUBSOIL TO A DEPTH OF 200mm. SUPPLY AND INSTALL TO A DEPTH 300mm THE FOLLOWING SOIL MIX:

SOIL DEPTH:

TURF PLANTING 150mm 300mm

SOIL MIX:

BLACK LOAM 60%
COARSE WASHED RIVER SAND 40%
LAYER 50mm DEEP
CULTIVATE A 50mm LAYER OF ORGANIC
ADD MIX INTO THE TOP 100mm OF SOIL MIX
COMPOSITION
TREATED HARDWOOD SAWDUST 30%
PINE PARK FINES 40%
COMPOSTED MANURE 30%

TREE PLANTING AREAS TO BE MOUNTED 300MM ABOVE THE EXISTING GROUND LINE TO IMPROVE DRAINAGE FROM PLANTING HOLES. TREE HOLES TO BE EXCAVATED TWO TIMES LARGER THAN THE ROOT BALL AND BACKFILLED WITH SOIL MIX AS SPECIFIED ABOVE.

ON SLAB PLANTERS:

DRAINAGE LAYER

AFTER WATERPROOFING OF PLANTERS LAY DRAINAGE LAYER WHICH SHALL INCLUDE:

- * 40mm ATLANTIS DRAINAGE CELL OR SIMILAR APPROVED.
- * FILTER FABRIC EQUIVALENT TO ICI TERRA FIRMA 700.
- * WASHED RIVER SAND LAYER 50mm IN DEPTH.

LIGHT WEIGHT SOIL MIX:

LIGHT WEIGHT SOIL MIX SHALL BE COMPOSED OF THE FOLLOWING MATERIALS AND MIXED IN THE GIVEN PROPORTIONS TO PRODUCE A MATERIAL WITH A PH. RANGE OF 6.0-6.5.

- * 30% BLACK LOAM
- * 30% DOUBLE WASHED COURSE RIVER SAND
- * 20% BOTANY HUMUS
- * 10% COMPOSTED BARK FINES
- * 10% COMPOSTED HARDWOOD SAWDUST

MINIMUM SOILS STANDARDS FOR PLANTS SIZES ARE PROVIDED IN ACCORDANCE WITH THE TABLE BELOW.

TREE SIZE	HEIGHT	SPREAD	MIN SOIL AREA	MIN SOIL DEPTH
LARGE TREES	>12m	>8m	10X 10m	1200mm
MEDIUM TREES	8-12m	4-8m	6X6m	1000mm
SMALL TREES	5-8m	<4m	3.5 X 3.5m	800mm
SHRUBS	-	-	N/A	500-600mm
GROUND COVER	-	-	N/A	300-450mm
TURF	-	-	N/A	200mm

TURF:

ALL TURFED AREAS TO HAVE ADEQUATE DRAINAGE WITH A MINIMUM LAYER OF TURF UNDERLAY OR CLEAN TOPSOIL OVER PREPARED SUB GRADE. TURF TO BE SOFT LEAF BUFFALO I.E 'SIR WALTER' OR AAS SPECIFIED BY A RECOGNIZED LICENSED COMMERCIAL FARM WITH A CERTIFICATE OF AUTHENTICITY SUPPLIED.

MULCH:

SUPPLY AND PLACE 75mm LAYER OF PINE BARK HORTICULTURAL GRADE MULCH, (GRADED IN SIZE 15mm x 15mm x 15mm, FREE FROM WOOD SLIVERS). SET DOWN 25mm FROM ADJACENT PAVING.

PLANT MATERIALS:

ALL PLANTS SHALL BE TRUE TO TYPE, OF HEALTHY GROWTH DISEASE FREE NURSERY STOCK AND NOT DISPLAYING RESTRICTED GROWTH PATTERNS. SHOULD NURSERY STOCK AND NOT DISPLAYING RESTRICTED GROWTH PATTERNS. SHOULD OBTAIN PRIOR APPROVAL OF THE LANDSCAPE ARCHITECT. NO VARIEGATED STRAIN SHALL BE USED. ALLOW FOR SLOW RELEASE FERTILIZER TO ALL PLANTS APPLIED AT THE MANUFACTURERS

RECOMMENDED RATE TO BE SAME OR SIMILAR TO MASS PLANTED AREAS: ALLOW 2 SHIRLEYS SLOW RELEASE KOKOI PELLETS PER 5 - 35 LITER PLANT AND ONE PER 150mm PLANT TURF AREAS: ALLOW SHELLEYS NO.17 35 LITER PLANT AND ONE PER 150mm PLANT TURF AREAS: ALLOW SHELLEYS NO.17 MANUFACTURERS INSTRUCTIONS.

STAKES AND TIES:

DURABLE HARDWOOD, STRAIGHT, SIZE SHALL BE 50X50X180 WITH TIES SPACED APPROXIMATELY 300mm APART. DRIVE STAKES 600mm INTO THE GROUND ON THE WINDWARD SIDE OF THE PLANT. TIES SHALL BE 50mm HESSIAN WEBBING FIXED IN A FIGURE OF THE EIGHT PATTERN.

PLANT ESTABLISHMENT PERIOD:

FROM THE DATE OF PRACTICAL COMPLETION, THERE SHALL BE A PERIOD OF 26 WEEKS FOR THE PLANTING ESTABLISHMENT PERIOD. ANY FAILED PLANTS SHALL BE REPLACED WITH THE SAME TYPE AND SPECIES. THE MULCHED SURFACES SHALL BE MAINTAINED IN A NEAT AND TIDY CONDITION. STAKES AND TIES SHALL BE ADJUSTED AS REQUIRED AND THE TURF SHALL BE REGULARLY MOWED TO MAINTAIN A HEALTHY GROUND COVER. A CONSTANT WATER REGIME SHALL BE MAINTAINED TO ENSURE HEALTHY GROWTH OF ALL PLANT MATERIAL.

ALL PLANTING AREAS TO BE SUPPLIED WITH A FULLY AUTOMATIC IRRIGATION SYSTEM, SHRUB RISERS AND DRIP SYSTEM ON PVC LATERALS. THE IRRIGATION SYSTEM SHALL MEET ALL THE REQUIREMENTS OF THE WATER BOARD AND ELECTRICITY SUPPLY AUTHORITY AND RELEVANT AUSTRALIAN STANDARDS.

APPROVED CONTROLLER. CONNECTION TO THE WATER BOARD MAINS TO BE THROUGH AN APPROVED REDUCED PRESSURE ZONE DEVICE INSTALLED TO THE WATER BOARD REGULATIONS.

PARTICULAR ATTENTION SHOULD BE PAID BY THE CONTRACTOR TO ENSURE MINIMAL OVERSPRAY ONTO PATHS, BUILDINGS AND ADJACENT PROPERTIES BY CORRECT HEAD PLACEMENT AND ADJUSTMENT OF ARC PATTERNS. NOZZLES TO BE MANUALLY TRIMMED TO SUIT AREA OF COVERAGE AND MINIMISE OVER SPRAY.

LAY PIPES TO MINIMISE LENGTH AND PLACE HEADS TO PROVIDE EVEN COVERAGE. ALL PIPES AND CABLE TO BE INSTALLED IN A COMMON TRENCH WHERE POSSIBLE.

TREE PLANTING DETAIL

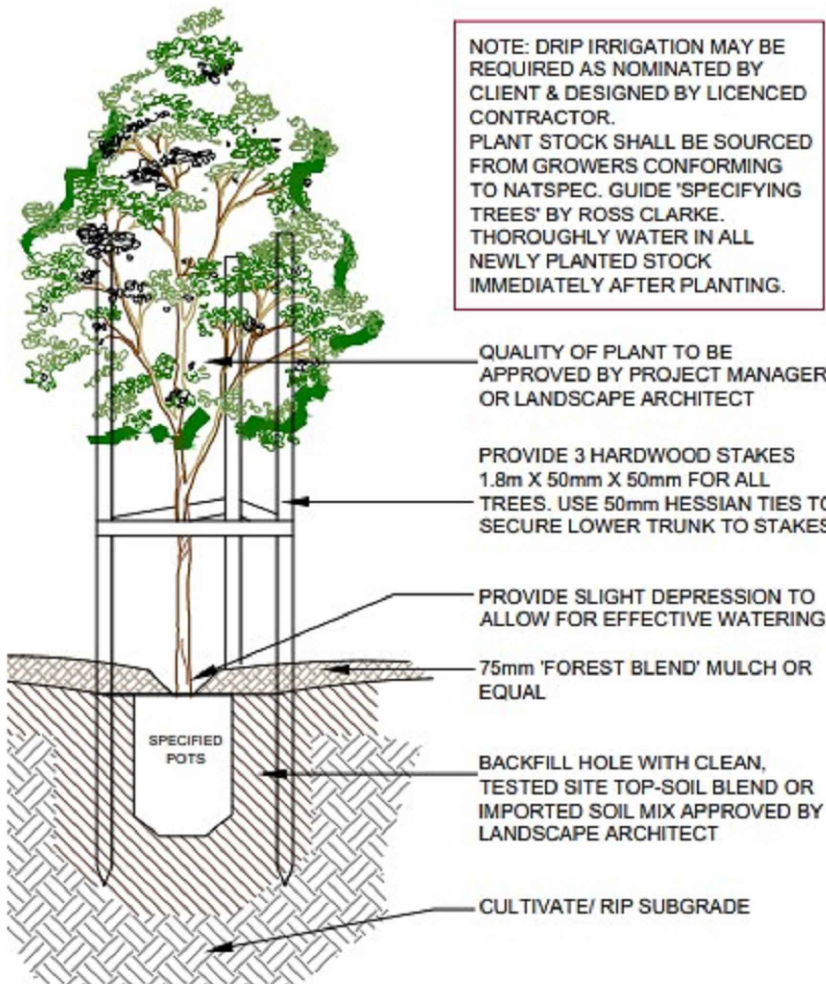

TREE PLANTING DETAIL

BRICK EDGE & GRASS DETAIL

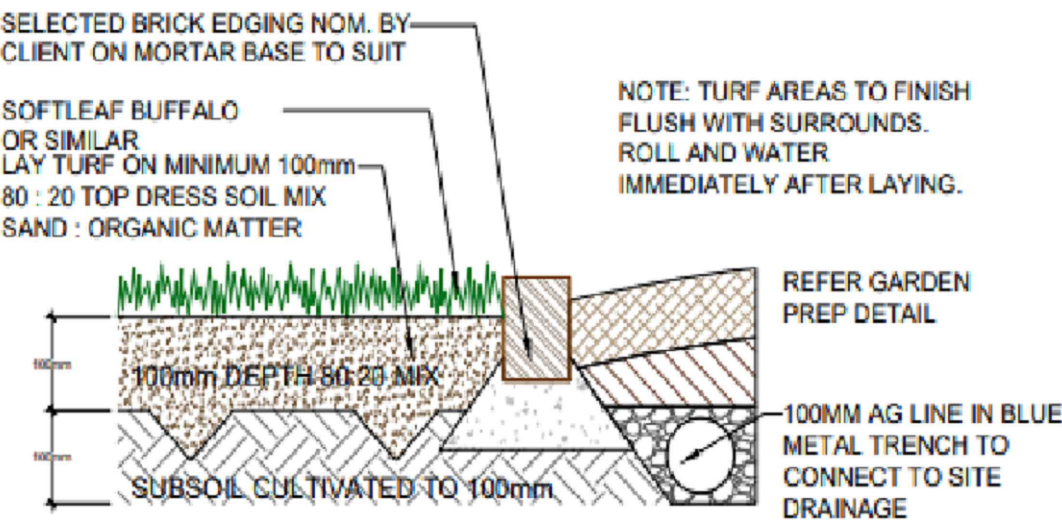

TYPICAL GARDEN PREPARATION DETAIL

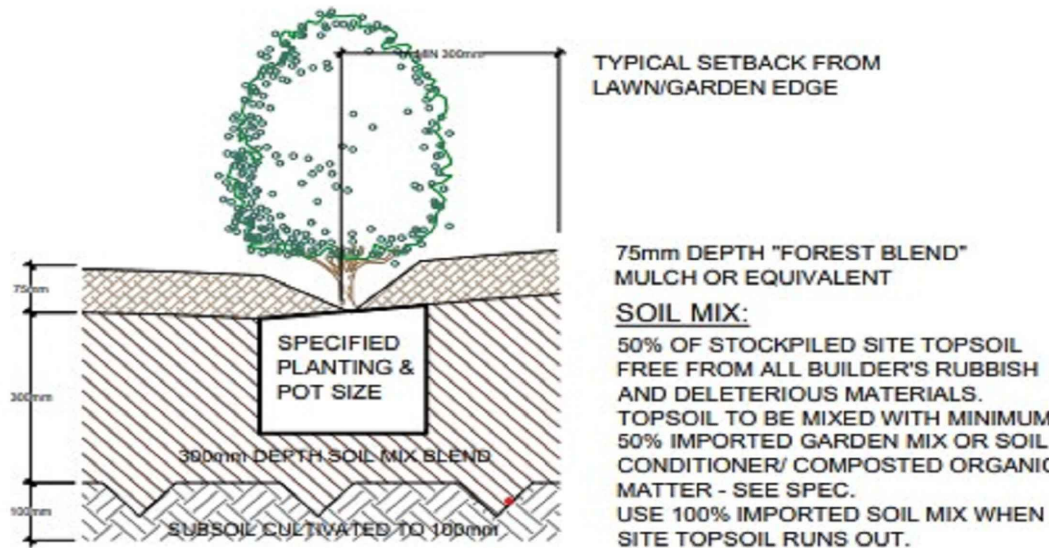

ELAEOCARPUS RETICULATUS

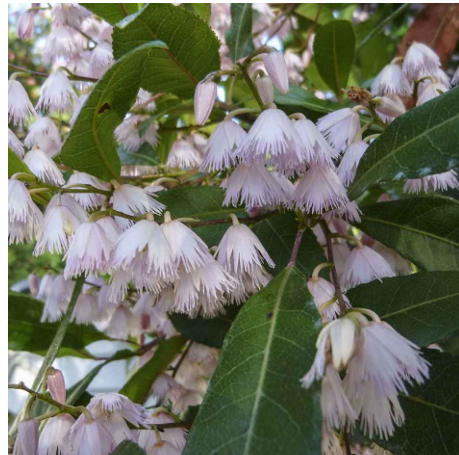

LAGERSTROEMIA INDICA



ACMENA SMITHII VAR MINOR

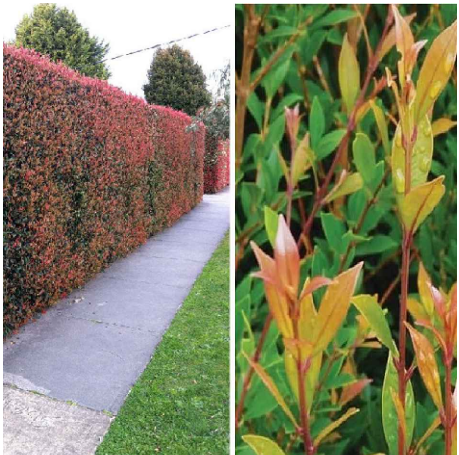

GREVILLEA MOONLIGHT



METROSIDEROS EXCELSA

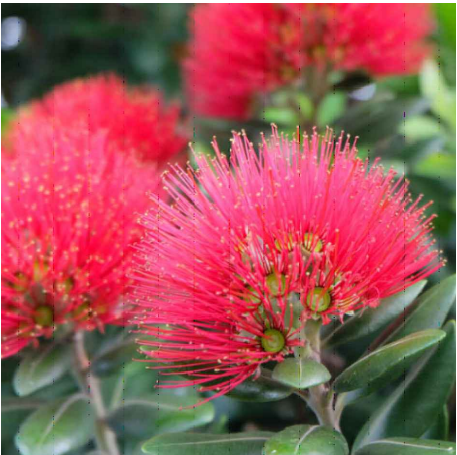

MURRAYA PANICULATA



SYZYGium HOT FLUSH

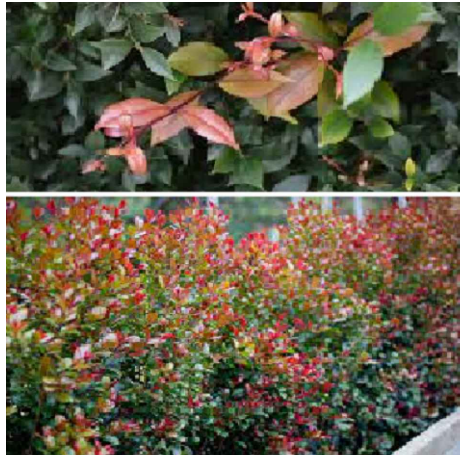

VIBURNUM ODORATISSIMUM



DIANELLA CAERULEA

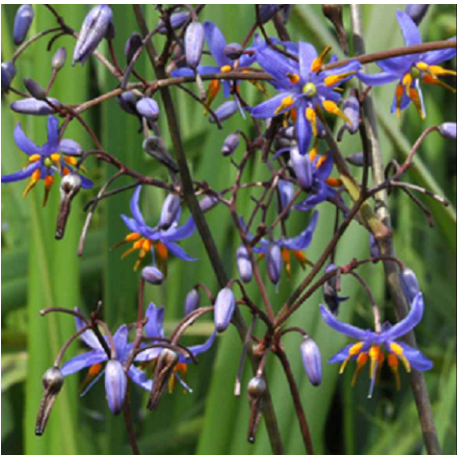

LOMANDRA TANIKA



AMENDMENTS	DESCRIPTION	BY	DATE
REVISION A	SUBMISSION FOR COUNCIL	SA	8.04.2025

CONSULTANT:	PROJECT:
-	72 CENTAUR STREET REVESBY
DRAWING NO:	SHEET NO.
2025-142	03
DATE:	DRAWING BY:
8.04.2025	SA

DRAWING TITLE:
PLANTING SCHEDULE AND NOTES SPECIFICATIONS PLAN
REV.
A
SCALE:
-